

S E C R E T

SECTION VII

M I S C E L L A N E O U S

S E C R E T

L-1084

S E C R E T

HEADQUARTERS 103d INFANTRY DIVISION
Office of the Commanding General

4 December 1944

SUBJECT: Commendation.

TO : The Members of the 410th Infantry.

1. In addition to the commendation to the entire personnel of the 103d Division for its aggressive, rapid and successful passage of the Vosges Mountains from St. Die to Barr, Itterswiller and Dambach, the 410th Infantry is particularly commended for its action from Lusse through Ville to Itterswiller.
2. Pushing boldly by the high trails from Ordon to the heights dominating Fouchy, bypassing the strong valley positions, capturing the mountain positions, surrounded by enemy strong points in all directions, you flanked the hostile Ranrupt-Climont Mountain-Fouillaupre line. This action, in penetrating rapidly seven kilometers to the enemy's rear threw him into confusion and resulted in your capture of Ville.
3. By your attack from Ville to Itterswiller in the face of the bitterest resistance, including repeated heavy counterattack, you insured the success of the flanking action of the 411th Infantry to the north.
4. These actions are both worthy of historical record and have earned for you this special commendation.
5. The Commanding Officer of the 410th Infantry will provide a copy of this commendation to each officer and will have it read to all members of his command at the first opportunity.

s/ C. C. Haffner, Jr.
t/ C. C. HAFFNER, JR.,
Major General, United States Army,
Commanding.

A true copy:

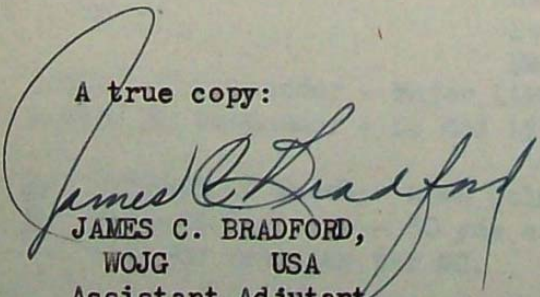
JAMES C. BRADFORD,
WOJG USA
Assistant Adjutant.

S E C R E T

~~SECRET~~

103D INFANTRY DIVISION

Office of the
Commanding General

24 December 1944

SUBJECT: Commendation.

TO : Colonel Henry J. P. Harding, Commanding Officer, 410th
Infantry.

1. It is a pleasure to repeat to you and to all members of the 410th Infantry, along with my season's greetings, a commendation for your aggressive and bold attack through the VOSGES MOUNTAINS and your attack North across the German border. The devotion to duty and the all-out effort of all members of your Command are worthy of particular comment.

2. I am looking forward with confidence to a continuation of your splendid performance which has already earned for the 410th Infantry a high reputation throughout this Army.

3. Inspecting officers from Corps, Army, and SHAEF have all commented on the high degree of military courtesy and the proper wearing of the uniform by members of this Division. There is no doubt that the alertness and the soldierly quality which this evidences has been a material factor in our success to date. It is my desire that you give the maintenance of these high standards your unremitting attention.

s/ C. C. Haffner, Jr.
t/ C. C. HAFFNER, JR.,
Major General, United States Army,
Commanding.

A True Copy:

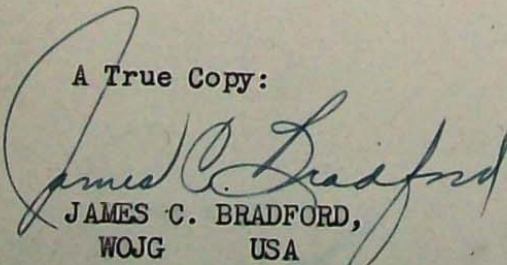
JAMES C. BRADFORD,
WOJG USA
Assistant Adjutant.

~~SECRET~~

S E C R E THQ 410TH INFANTRY
BLIENSCHWILLER, FRANCE
040500 December 1944

MOVEMENT ORDER NO. 4

MAPS: Central Europe-Strasbourg 1/100,000

1. Enemy air is active.
2.
 - a. 410th Inf less 3d Bn marches by motor from vic BLIENSCHWILLER to assembly area vic MITTLEHAUSEN beginning 040900 December 1944.
 - b. Route: EPFIG - ST PIERRE - GERTWILLER - OBERNAI - MOLSHEIM - KIRCHHEIM - KUTTOLSHEIM - SCHNERSCHEIM - MITTLEHAUSEN.
 - c. Regimental Regulating Point - BLIENSCHWILLER (V768715).
 - d. IP - EPFIG (RJ FINCKWILLER & ST PIERRE RD).
 - e. Regimental Release Point - MITTLEHAUSEN.
 - f. Billeting Party - SOP.
 - g. Route Marker Party - MP Platoon and AT Mine Platoon. Cross IP at 0700.
 - h. Personnel Carriers:
 - 1st and 2nd Bns - 21
 - Hq and Hq Co - 4
 - Service Co - 3
 - Route Marker Party - 1

All 2 $\frac{1}{2}$ -ton LWB picked up by Motor Officer at Regtl CP at 0600.

3. ORDER OF MARCH:

<u>Serial #1</u>	<u>Organization</u>	<u>Cross IP</u>
MU 1	2nd Battalion	0900
MU 2	2nd Battalion	0910
MU 3	2nd Battalion	0920
MU 4	Hq, Hq Co, Med Det	0930
MU 5	Cannon Co	0940

Serial #2

MU 1	Antitank Co	1004
MU 2	1st Battalion	1014
MU 3	1st Battalion	1024
MU 4	1st Battalion	1034
MU 5	Service Co & Co B, 328th Med Bn	1044

Serial #1 Commander - Major LAMPERT

Serial #2 Commander - Lt Col LYNCH

- a. Conduct of March: Open Column SM 4.
- b. Minimum Distance - 50 yds at all times enroute or at halt. Not more than 25 vehicles per MU.

S E C R E T

1

307

S E C R E T

MOVEMENT ORDER NO. 4 (Con'td)

3. c. Maximum Speed - Per control vehicle - 18 mph.
MU control vehicle - 20 mph.
Other vehicles - 30 mph.
 - d. Halts - None.
 - e. Personnel Carriers - To down and lashed. AA security - Two air guards per personnel carrier. In case of air attack, vehicles will halt, personnel will disperse and all available weapons will be brought to bear on attacking planes.
4. Radio silence.
 5. One company of 2nd Bn with kitchen will move to GOUGENHEIM from MITTLEHAUSEN. This company will act as CP security for Division. Company Commander contact Major YOW at GOUGENHEIM upon arrival.

HARDING
Colonel

OFFICIAL:

McCARTHY
Asst S-3

DISTRIBUTION:

- 1 ea Bn
- 1 - AT Co
- 1 - Cn Co
- 1 - Sv Co
- 1 - Hq Co
- 1 - 328th Med Bn (Co B)
- 1 - G-3, 103d Inf Div
- 1 - Med Det
- 1 - File

A True Copy:

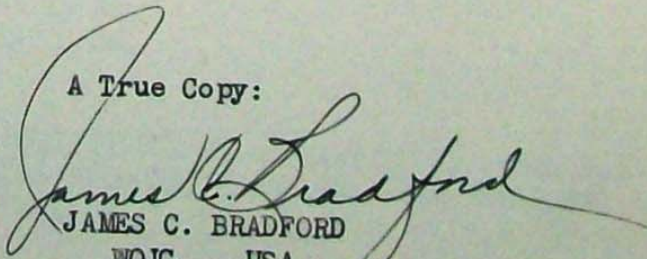
JAMES C. BRADFORD
WOJG USA
Assistant Adjutant

S E C R E T

2

308

S E C R E T

HQ 410TH INFANTRY
 Vic NIEDERMODERN, FRANCE
 (Q926137)
 092200 Dec 44

FO #2

MAPS: FRANCE 1/50,000
 HAGAUEAU XXXVIII - 14.

1. a. Int overlay.b. Friendly:

(1) 103d Inf Div atks 0530 10 Dec 44 on axis GRIESBACH (Q9532) - TRIMBACH (N2138) to seize high ground STUNDWILLER (R1836) - TRIMBACH-OBERSEEBACH (P1841) prepared to continue adv to RHINE R and assist 79th Inf Div to clear HAGENAU FOREST area.

(2) 411th Inf forces crossing ZINTZEL R seizes Phase Line "A" in zone and protects N flank of Div.

(3) 409th Inf assembles in SCHALKENDORF - RINGELDORF area by 1700 9 Dec prepared to follow atk of 411th Inf on Div O.

(4) Arty:

(a) 383d Op: (383d FA Bn, 69 AFA Bn): Direct support 410th Inf.

(b) Corps & Div Arty fire successive concentrations from H-15 to H-150.

(c) After initial preparation (H-15 to H hour) all fires W MERTZWILLER - HAGUENAU R on call.

(d) From H to H-150 successive preparation fired only E of MERTZWILLER - HAGUENAU Rd.

2. 410th Inf:

Atchd: Co B, 756th Tk Bn.

Co C, 3d Cml Bn.

Co A (-1st Plat) 601st TD Bn.

Co B, 328th Engr C Bn.

a. Atks 0530 10 Dec 44 forces crossing ZINTZEL R, seizes Phase Line "A" in Z.b. Prepares to continue atk to Div Obj.c. Protects Div right flank.3. a. 1st Bn:

Atchd: 3rd Plat plus one section Co "B", 756th Tk Bn.

2nd Plat Co "A" (-) 601st TD Bn.

3rd Plat, Co B, 328th Engr C Bn.

1st Plat, AT Co.

Mine Platoon, AT Co.

(1) Atk 0530, capture that part of MERTZWILLER NE of ZINTZEL R, establish bridgehead, block approaches to MERTZWILLER from NW, E and SE, seize hill 193 (9631), and prepare to seize LAUBACH on Regtl O.

b. 2nd Bn:

Outpost ZINTZEL R with 2 Platoons from (972283) to (982281). Atk thru outpost, cut HAGUENAU - MERTZWILLER Rd on right flank, seize and hold rectangle on overlay, clear woods to N & E in Z, and protect Regtl S flank.

S E C R E T

1

309

S E C R E T

FO #2 (Continued)

- c. AT Co: (Less ___ Plat, Mine Plat): Relieve 2nd Bn AT Plat E of NEUBOURG-MERTZWILLER Rd prior to daylight. Remainder await O in UEBERACH.
3. d. Cn Co: Direct support of 410th Inf. Fires on call.
- e. I & R Plat: Patrol rd and area shown on overlay. Reports to advance CP.
- f. Co "C", 3d Cml Bn: Overlay.
- g. Co "B", 328th Engr C Bn (less 2 Platoons): Prepare to cross R behind 1st Bn rifle Co's, sweep rds in MERTZWILLER, other roads on order.
- h. Co "B", 756th Tk Bn (less ___ Plat plus one section): Prepare to cross ZINTZEL R on Regtl O.
- i. Co "A" (-) 601st TD Bn (less 2nd Plat): Support atk from present position prepared to displace on order.
- j. Regtl Res (3d Bn): Assemble as shown on overlay by daylight 10 Dec 44. Prepare to cross ZINTZEL R between MERTZWILLER and N Regtl Boundary to seize LAUBACH on Regtl O. Furnish protection at 2nd Road Block at (_____).
- x. (1) Attachments effective at once.
(2) Contact SOP.
4. Adm instructions later.
5. a. Adv CO opens (960275) 0530, 10 Dec 44.
b. Other CP's to be reported.
c. Bns report CP's.

HARDING
Col

OFFICIAL:

SILVER
S-3DISTRIBUTION:

1 ea Bn
1 - AT Co
1 - Cn Co
1 - Hq Co
1 - Sv Co
1 - Med Det
1 - Co B, 756th Tk Bn
1 - Co C, 3d Cml Bn
1 - Co A, 601st TD Bn
1 - Co B, 328th Engr C Bn
1 - Co B, 328th Med Bn
1 - G-3, 103d Inf Div
1 - S-3 file

A True Copy:

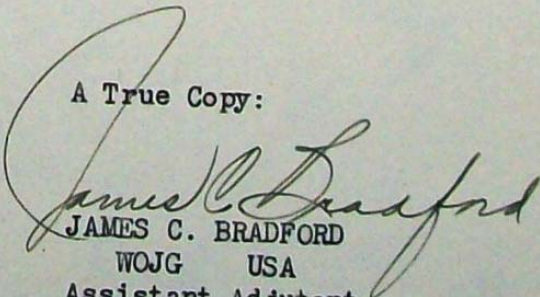

JAMES C. BRADFORD
WOJG USA
Assistant Adjutant

S E C R E T

S E C R E T

410TH INFANTRY
DRACHENBRONN, FRANCE
18 Dec 44, 2330

OPERATIONS INSTRUCTION)

NUMBER :
12)

MAPS: FRANCE 1/50,000 Sheets XXXVIII - 14; XXXIX - 13.

1. 410th Inf moves to positions as shown at 190800A Dec 44.
2. 1st Bn (Reinf):
 - (a) Marches 0730 to area as shown.
 - (b) Protect Div right flank from Phase Line "F" north to and including SCHNEIGEN, upon arrival.
 - (c) Occupy high ground vic C.P. 107 with minimum force holding bulk of Bn in assembly area.
 - (d) Place AT weapons and be prepared to mine and block roads leading to SCHWEIGEN and WISSEMBOURG from NE, E and SE.
3. 3rd Bn (Reinf):
 - (a) Move by marching to position as shown at 0800. Close by 1000. Organic vehicles using route Blue must close in new area by 0700.
 - (b) Be prepared to counterattack to W up valley in direction BOBENTHAL or to follow 411th Inf promptly on order.
4. 2nd Bn (less Co E): Move by marching 0800 to previously reconnoitered position vic OBERHOFFEN.
5. AT Co (Less 1 Plat): Move vic OBERHOFFEN, see Par 9c.
6. Cn Co: Move vic OBERHOFFEN, see Par 9b.
7. Co "E": Continue present mission until further orders.
8. Co "B": 47th Tk Bn: Remain present position, assume alert status 0800 prepared to move vic OBERHOFFEN on order.
9. ORDER OF MARCH:
 - (a) 1st Bn: Foot troops - route RED - 0700.
Vehicles:
 - (1) 1st MU: Bn organic - route Red - 0730.
 - (2) 2nd MU: 1 Plat AT Co, 1 Plat Co A, 614th TD's - route Red - 0800.
 - (b) Cn Co: Route Blue - IP - 0800.
 - (c) AT Co (-): Route Blue - IP - 0820.

S E C R E T
1

S E C R E T

O. I. #12 (Continued)

9. (d) Organic 2nd Bn: Route Blue - IP - 0840. Foot troops march 0800 by most direct route.
- (e) 3rd Bn: Foot troops 0800 - route Black.
Organic 0615 - route Black.
- X. (a) Organizations report when closed.
- (b) Attachments - no change.
- (c) Training in Atk of Fortified Area and use of pack boards to be continued upon arrival at new positions.
- (d) 1st & 3rd Bns continue to push Rcn behind assault regiments.
10. (a) Regimental CP - OBERHOFFEN.
- (b) Organizations report CP's.

HARDING
Col

OFFICIAL:

s/ Silver
t/ SILVER
S-3

1 - overlay attached.

DISTRIBUTION:

- 1 - ea Bn
- 1 - AT Co
- 1 - Cn Co
- 1 - 74th Tk Bn
- 1 - 614th TD Bn
- 1 - G-3, 103d Div
- 1 - S-3 file.

A True Copy:

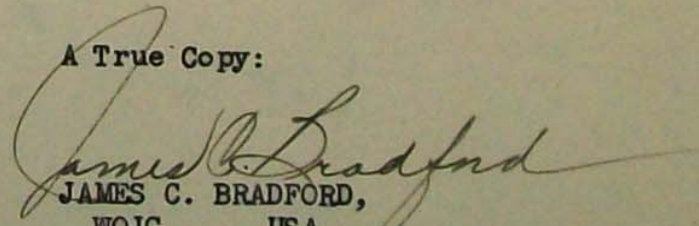
JAMES C. BRADFORD,
WOJG USA
Assistant Adjutant.

S E C R E T

S E C R E T

HQ 410TH INFANTRY
 Vic GUEBENHOUSE, FRANCE
 (420532)
 251000A Dec 44

FO #3

MAPS: FRANCE 1/50,000 Sheets XXXV 12 & 13, XXXVI 12 & 13.

1. a. Previously issued.
- b. 103d Inf Div (Reinf) organizes and defends its sector with two Regts abreast.
2. a. 410th Inf (Reinf) organizes and defends right sector of Div zone employing not less than the equivalent of one R Co (Reinf) in establishing combat outposts, protects Div Right (E) flank.
- b. 383 FA Bn in direct support, 382 FA Bn reinf fires 383 FA Bn.
- c. Co B 328 Engr Bn direct support.
3. a. 1st Bn:
 Atchd: 2nd Plat Co A 614 TD Bn
 1st and 2nd Plats AT Co (- 1 Gun)
 Organize and defend left sector of Regtl zone.
- b. 2nd Bn:
 Atchd: 3rd Plat Co A 614 TD Bn
 1 Sqd 1st Plat AT Co
 (1) Organize and defend right sector of Regtl zone.
 (2) Occupy WOLFERDING with at least one platoon.
 (3) Establish guards on approaches to WOLFERDING, approaches to HUNDLING and IPPLING FROM N.
- c. AT Co (Less 3 platoons): Regtl control HUNDLING reconnoiter positions in either sector prepared to Reinf AT defense on principal avenues of approach on O.
- d. Cn Co: General support, be able to support OFL.
- e. I & R Plat: Conduct road patrols in area WOUSTVILLER, HAMBACH, WOLFERDING, SARRGUEMINES. Investigate suspicious civilian movement or reports of hostile parachute landings in area.
- f. Mine Platoon: Assist Bns in laying of mine fields then assemble at GUEBENHOUSE.
- g. Co A 614 TD Bn:
 (1) 1 Plat: atchd 3rd Bn.
 (2) 2 Plat: atchd 1st Bn.
 (3) 3 Plat: atchd 2nd Bn.
- h. Regtl Res: - 3d Bn:
 (1) Organize and occupy RRL with minimum force.
 (2) Remainder Bn mobile at DIEBLING.
 (3) Be prepared to C/Atk to NE, N, NW in defense of MLR.
 (4) Occupy IPPLING with 1 platoon and guard approaches.
 (5) Guard approach to HUNDLING FROM S.
 (6) Guard approaches to DIEBLING.

S E C R E T

1

S E C R E T

FO #3 (Continued)

- x. (1) All orgns conduct active rcn prepared on O to exploit enemy weaknesses developed by rcn.
(2) Cover in depth all principal avenues of approach by entrenchments, wire and AT mines.
(3) Cover all roads leading into sectors by road blocks, reinforced by AT mines and defended by fire.
(4) Front line Bns be prepared to mark lines on call.

4. Adm Instr later.

5. CP's:

- a. 410th Inf: GUEBENHOUSE.
b. 1st Bn : NOUSSEVILLER.
c. 2nd Bn : HUNDLING.
d. 3rd Bn : DIEBLING.

HARDING
Col

OFFICIAL:

/s/ Silver
/v/ SILVER
S-3

ANNEXES:

1 - Opn overlay

DISTRIBUTION:

1 ea Bn
1 AT Co
1 Cn Co
1 383 FA Bn
1 Co A 614 TD Bn
1 Plat 756 Tk Bn
1 G-3
2 File

A True Copy:

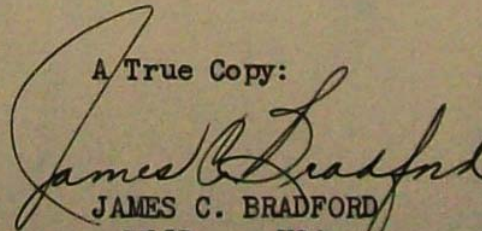

JAMES C. BRADFORD
WOJG USA
Assistant Adjutant

S E C R E T

2

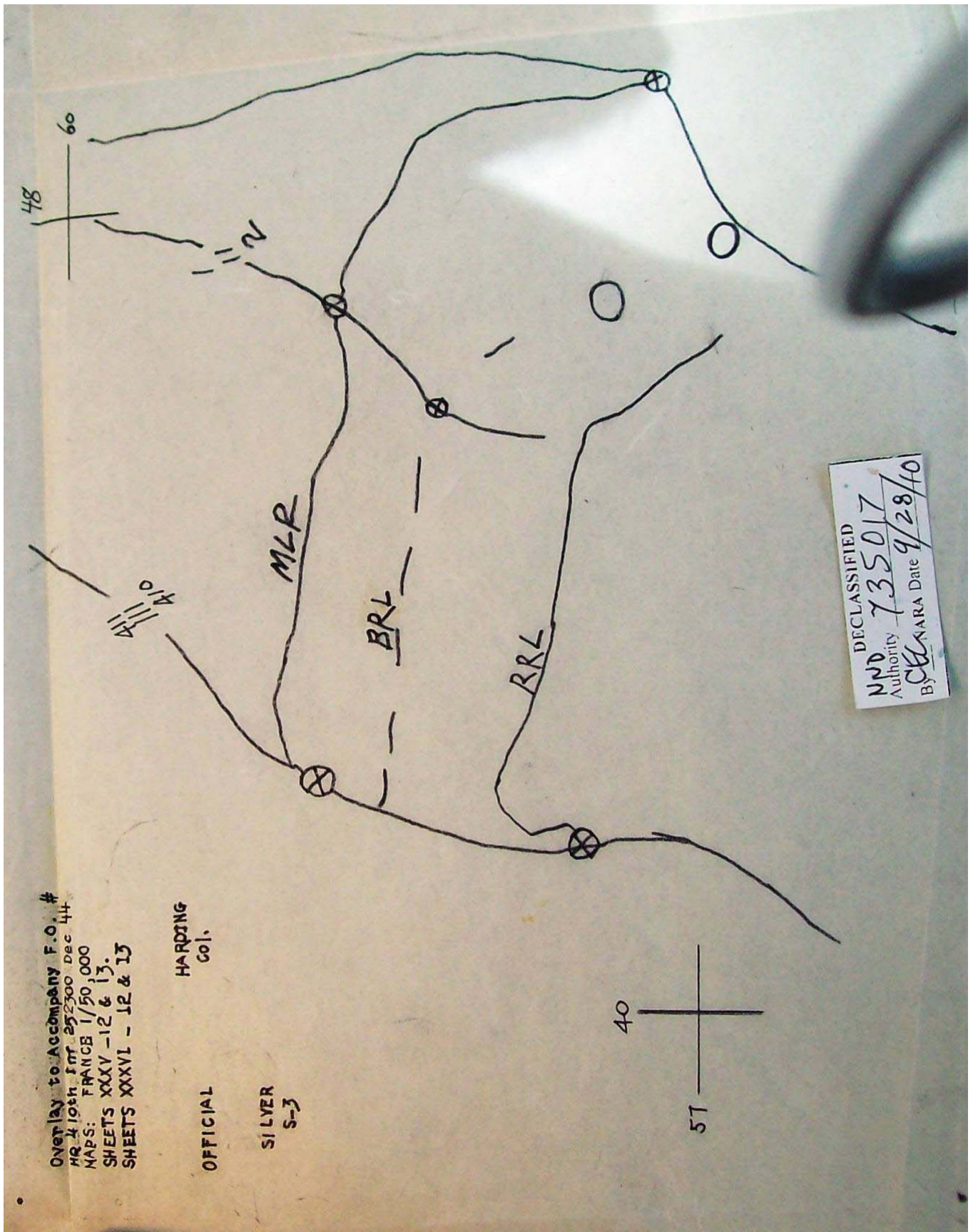

Overlay to Accompany F.O. #
HQ 410th Inf 252300 Dec 44
MAPS: FRANCE 1/50,000
SHEETS XXXV -12 & 13.
SHEETS XXXVI - 12 & 13

HARPING
Col.

OFFICIAL

SILVER
S-3

DECLASSIFIED
NND 735017
Authority
By [signature] NARA Date 9/28/10